

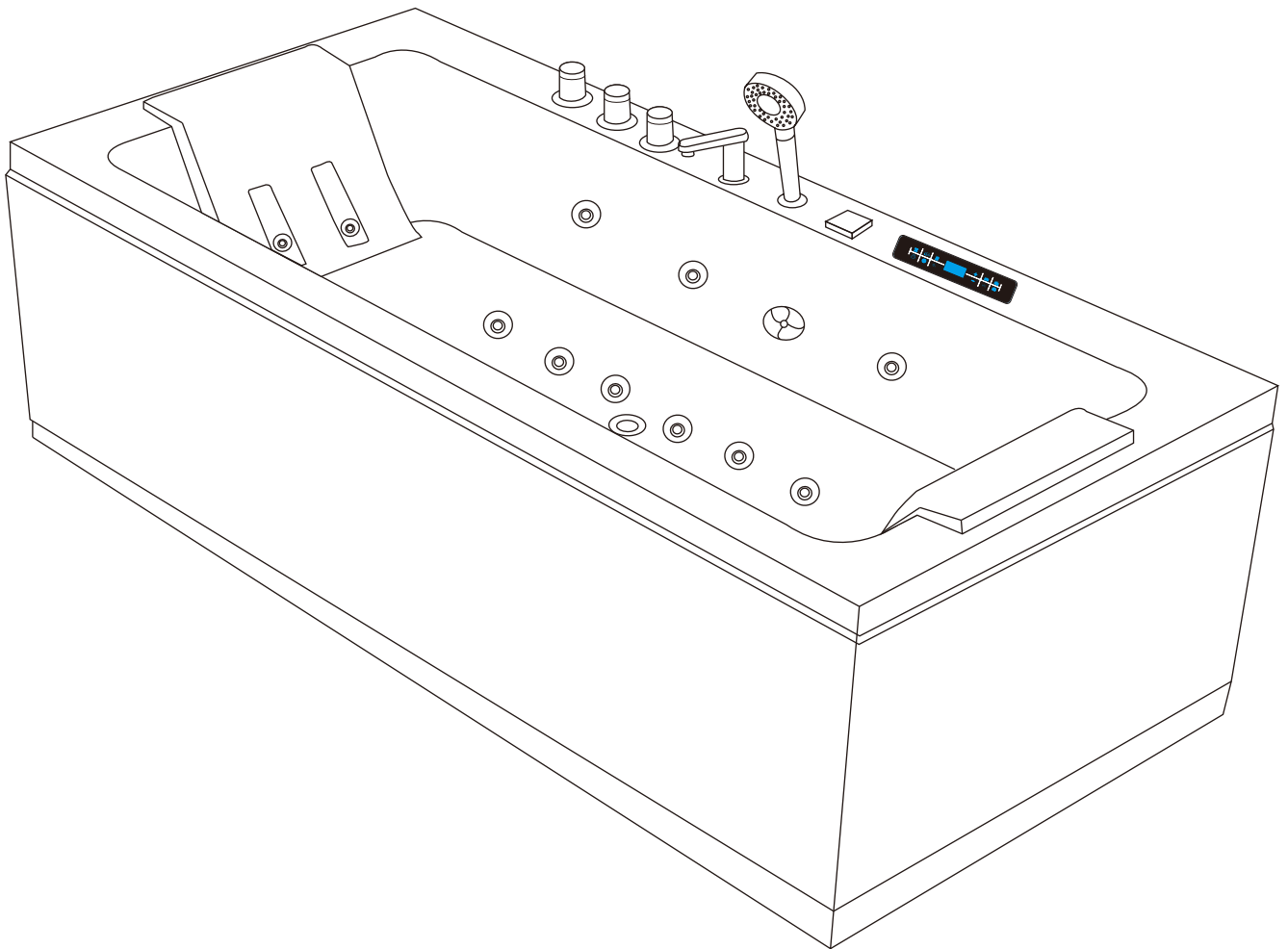

# Luxury Massage Bathtub



DELOS

1600x750x580mm

1700x800x580mm

1850x900x620mm

# Functional Introduction

- 1.Switch for hand shower & faucet
- 2.Cold water
- 3.Hot water
- 4.Faucet
- 5.Hand shower
- 6.Switch for speed
- 7.Computer panel

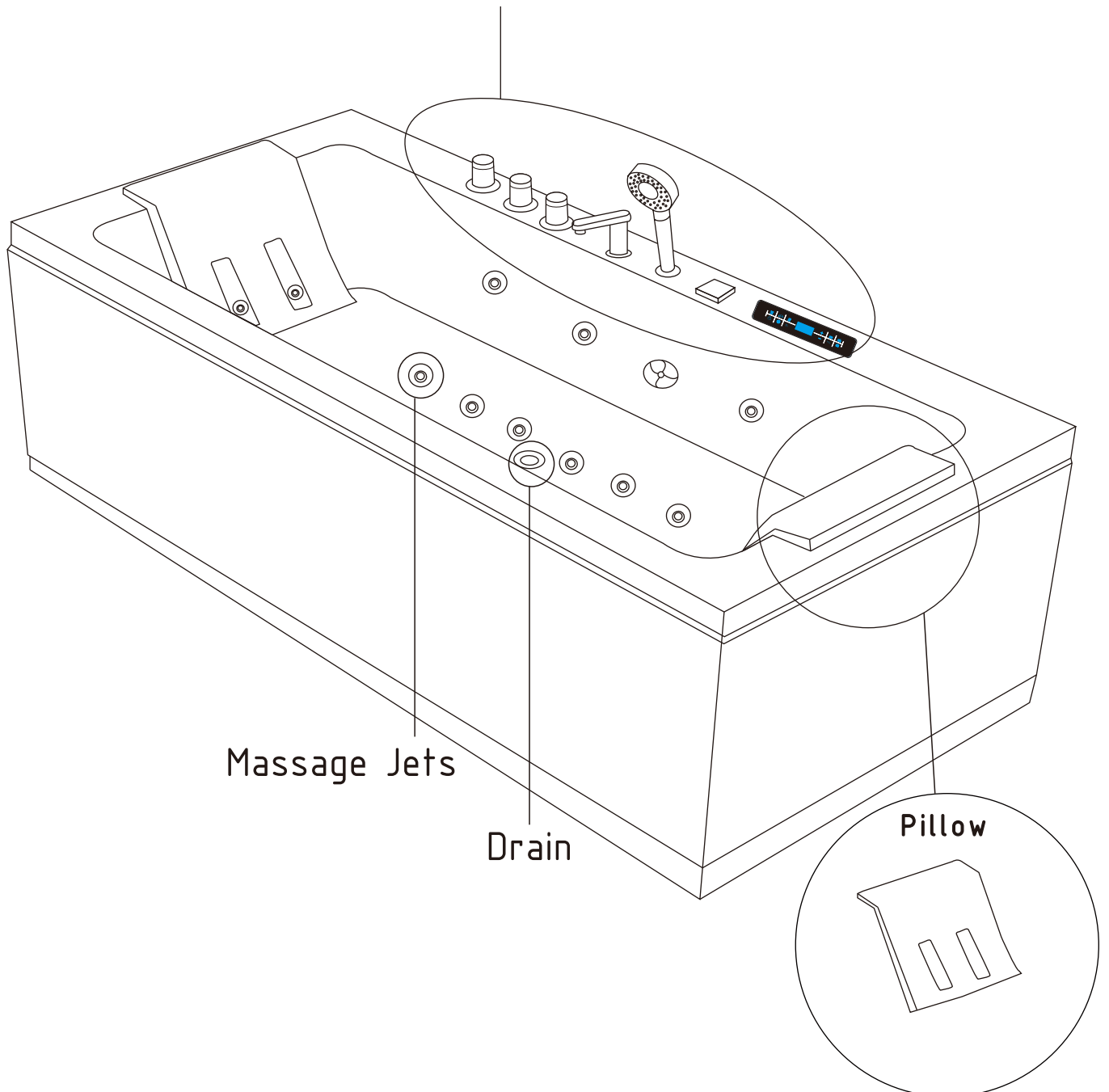

# Water & Electricity

## Position Design

Length unit: mm

1600x750x580mm

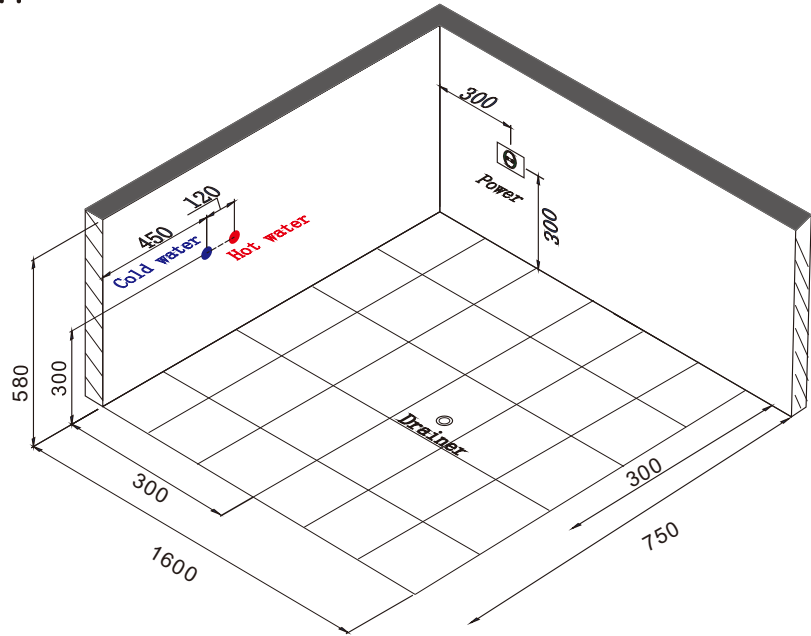

1700x800x580mm

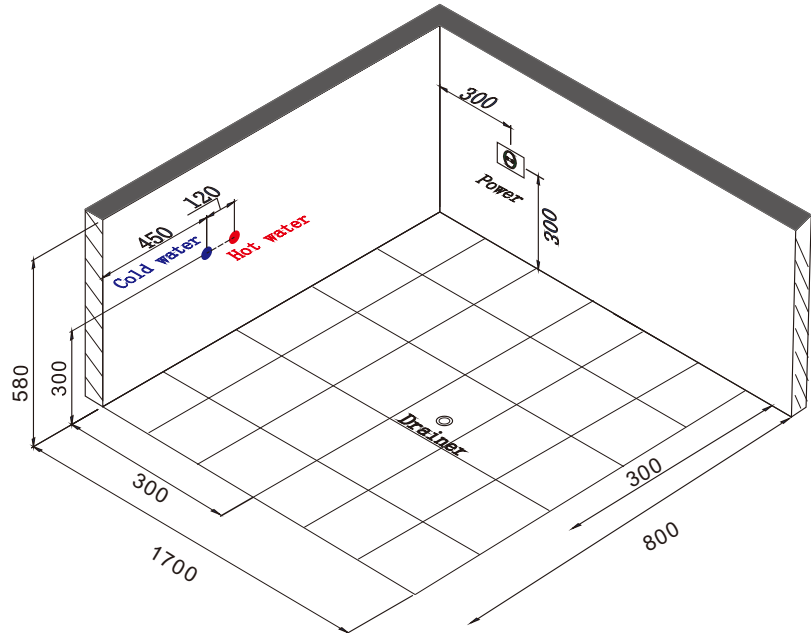

1850x900x620mm

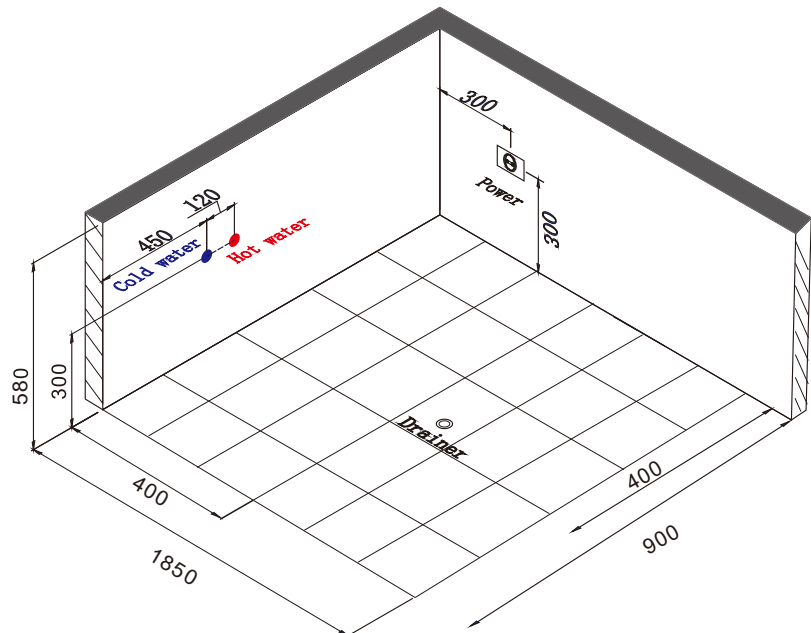



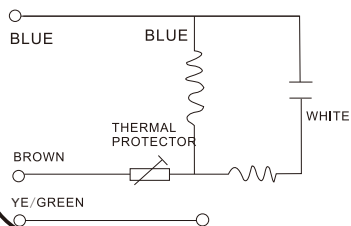

# Power Request

**DXD PUMP**

MODEL DXD-315 E AC 220-240V 50Hz 1125W CLASS F IPX5  
 MAX WATER TEMPERATURE 50°C 15u F/450V Hmin 1m



BLUE BLUE  
 BROWN THERMAL PROTECTOR  
 YE/GREEN WHITE



Ground properly!  
 Do Not Start Pump  
 Without Water!

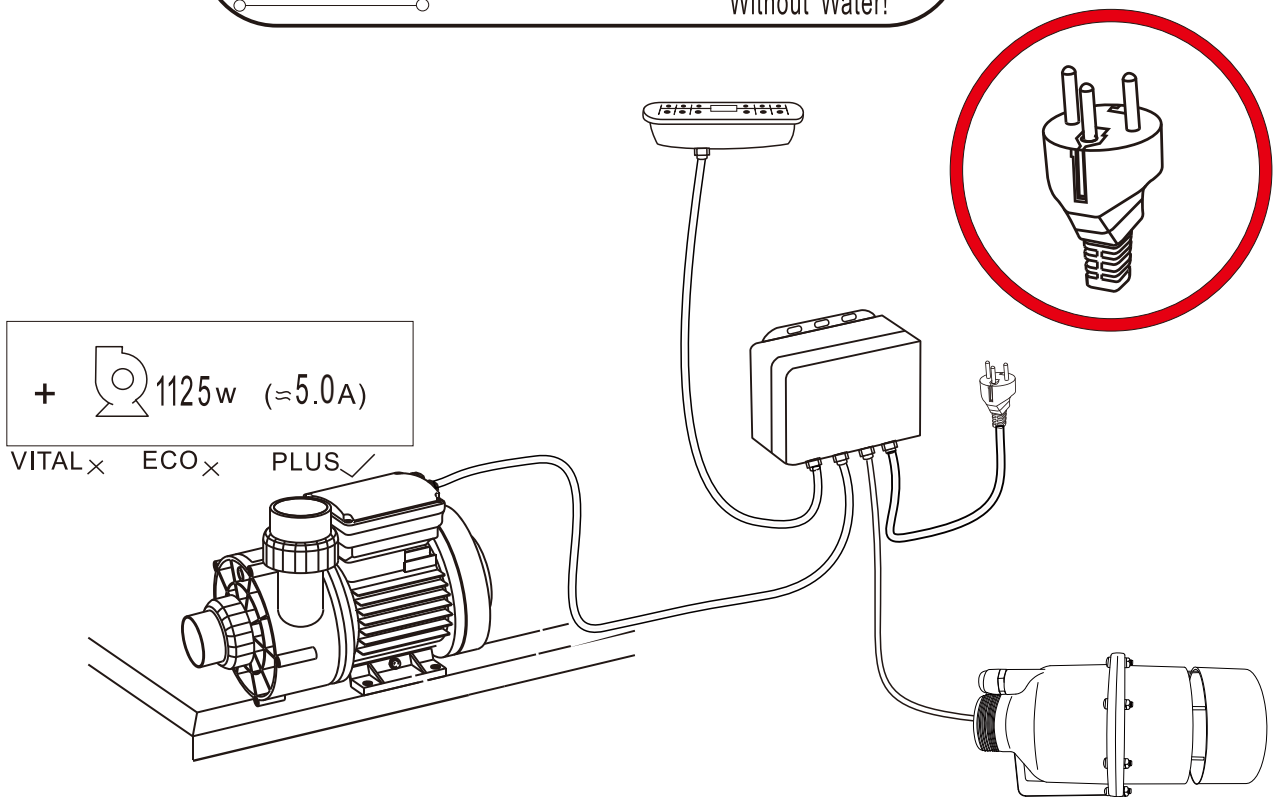

**DXD AIR PUMP**

MODEL DXD-6E-350 220-240V 50HZ/60HZ 350W  
 S1 CLASS 155(F)  
 IP X5

BAR CODE:



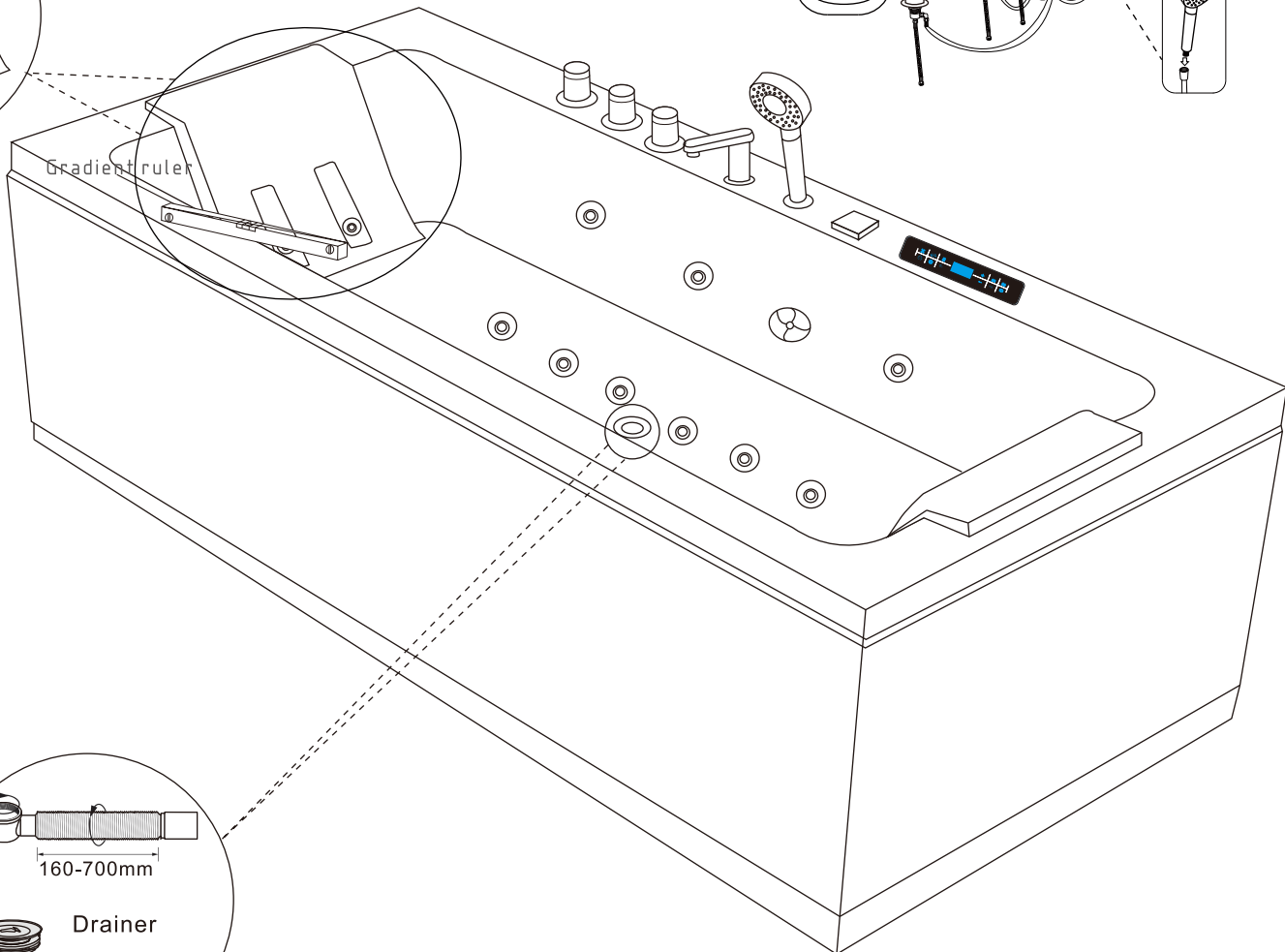
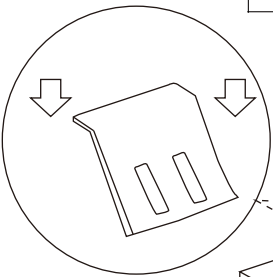
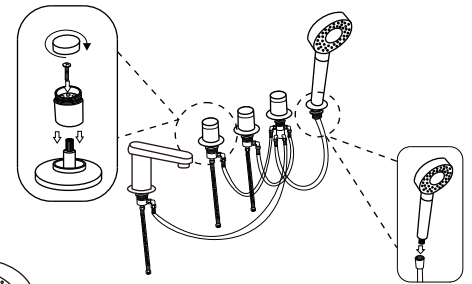
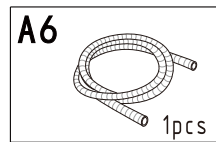
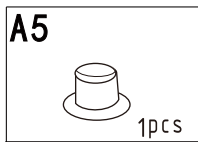
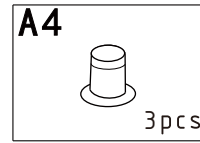
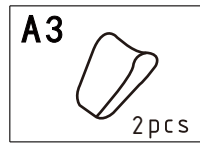
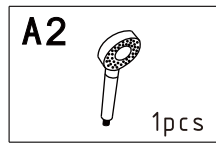
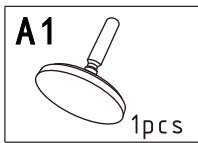
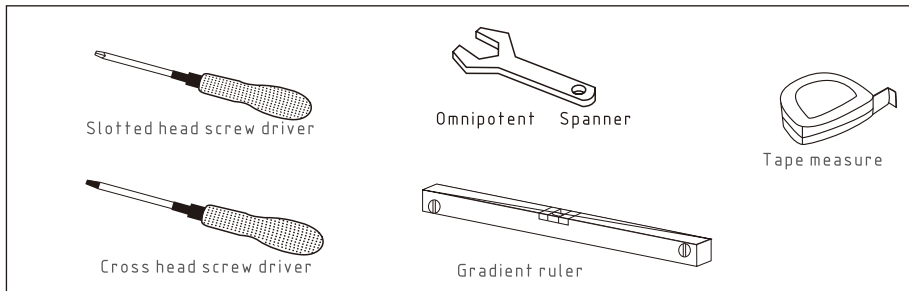

# Accessories

## Installation

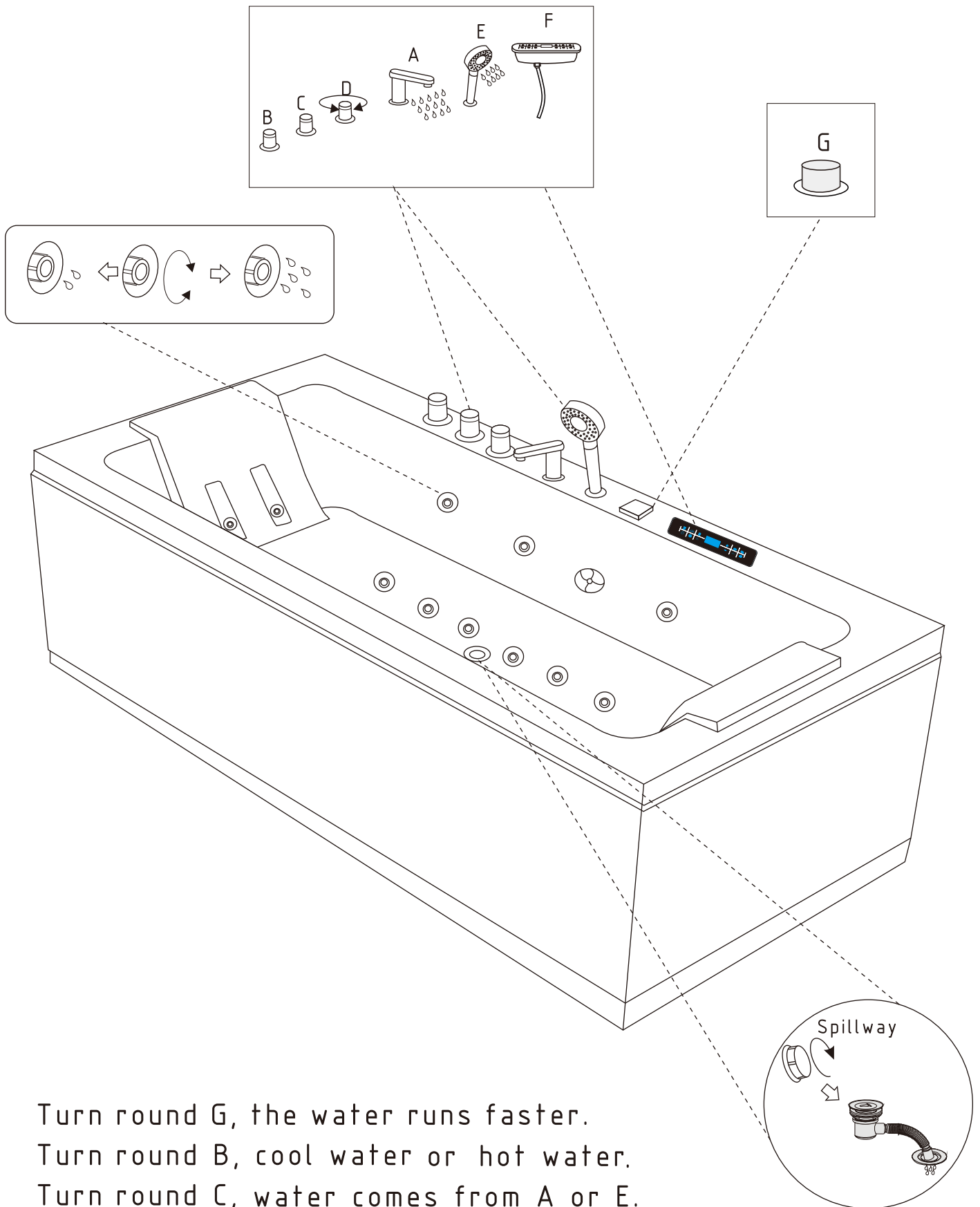

# Functional Instructions



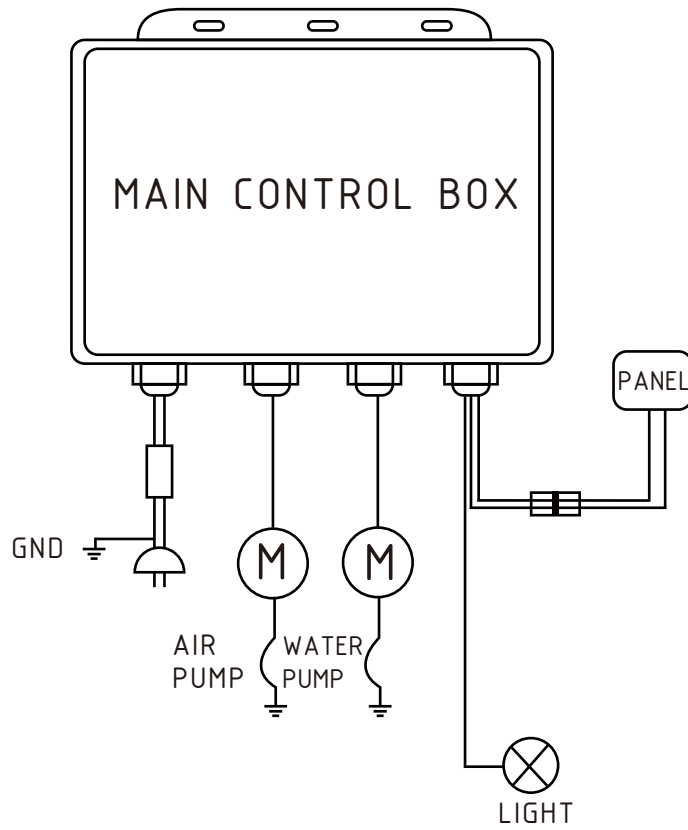

Schematic diagram of the panel

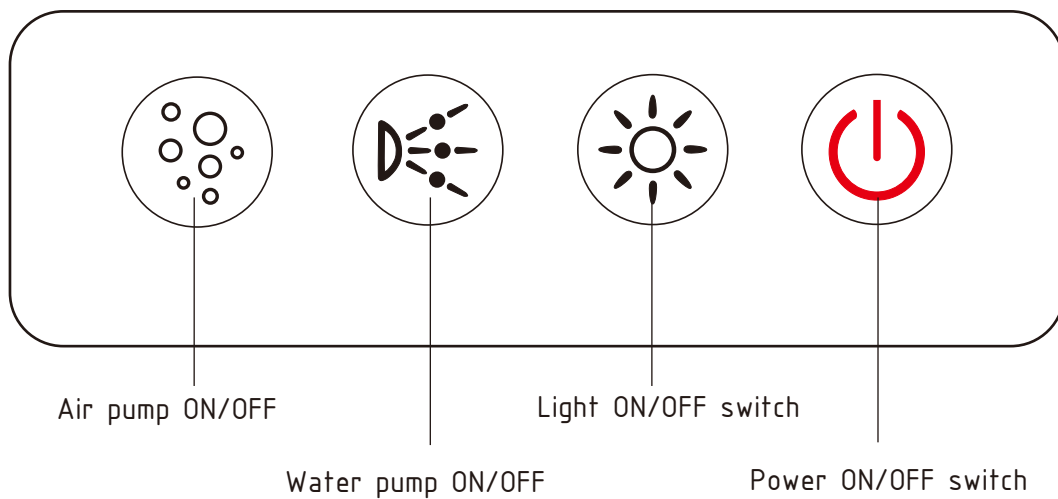

## Operation instruction and direction



Push down the switch, the controller is open, its status light is on, and other functions can be used only when power is ON.



Push down the button,the Water pump is on;  
repeat theoperation,it is off.



Push down the button,the Air pump is on;  
repeat theoperation,it is off.



Push down the button,the Light is on ;  
repeat the operation,it isoff.

Notice:their status lights are on when you press the buttononce,and  
their lights are off when the functions stop running.When there is  
no enough water,please don't open the function ofwater pump.

## Run Environment

① POWER:AC220V ② pump/WIND PUMP: AC220V ③ LIGHT:AC12V

## Notes of user

- ① Please read the instruction carefully when install the product,  
so that you can do it effectively in time.
- ② User should pay attention to the high-voltage on products marked  
signs,Not to touch their locations, ensure personal safety;
- ③ Don't expose the controller to the moist or high temperature  
environment to prevent fire or electric shock.  
Please towel thecontroller after using it.
- ④ Please keep water clean,no solid debris left.Otherwise,it  
will jam the backwater and the pipeline,resulting in damagingthe  
equipment or fittings.If jam happened, please turn off thepower  
to clean stems immediately,then restart it.
- ⑤ Please do not pull any of the output lines, not beat or throw  
the equipment at random,Otherwise crusts or inner parts will  
be broken.



- ⑥ Don't open the cover of the controller for there are dangerous parts in allowed for maintenance it. Only qualified servicemen are allowed for maintenance.
- ⑦ The used power supply must be in line with the specified voltage value shown on the controller otherwise it is not allowed to be used even burns out the controller.
- ⑧ The intervals of continuous power on and off must be over 30s for extending the use life of the controller.
- ⑨ Please do not plug or pull the control panel with electricity, otherwise the devices will be damaged or unusual conditions will appear. At the moment, turn off the power in seconds, restart it.
- ⑩ Please insert fittings (such as: light, speaker, valve, ozone sterilization, water pump, wind pump, steam generator, etc.) into corresponding output ports of equipment correctly, otherwise they will be damaged in order to cause danger.

## Solutions of basic problems

① Q: Why does not water pump run?

A: Firstly, please check whether there is a equipment with water level, if so, please check whether the water sensor contact with water is good, if not, please stop using it, then you can contact with my company staff.

① Q: Press lights, ozone, speakers, fan, air-conditioning and other functions, but why don't they start to run?

A: First, check whether the plug-in terminals contacts with each other well; if lights and ozone sterilization still fails to run, please turn on the fuse and ensure if it has blew out, which cutoff the whole system and stop running.